

Explain:

1. Characteristic:

Insulation impedance :3000MΩ MIN. at 500V DC
 Withstand voltage value :250V AC RMS for 1Minute
 temperature range : -45℃+85℃

2. Material Science:

Rubber core : PBT rated (black)
 Iron shell : SPCC, Front shell nickel plating Rear shell tin plating

110A 26 M 1 X
 1 2 3 4 5

1. Serial number:

110A=HDEC end punched optical hole

2. PIN distinguishing:

15=15PIN 26=26PIN 44=44PIN
 62=62PIN 78=78PIN

3. Male female distinction:

F=female M=male

4. Classification of plastics:

1=Black glue

5. Iron shell division:

A=Iron shell 12H B=Iron shell 24H
 C=Iron shell 48H D=Copper shell
 E=Stainless steel passivation
 F=Stainless steel nickel plating
 G=Gold plated iron shell

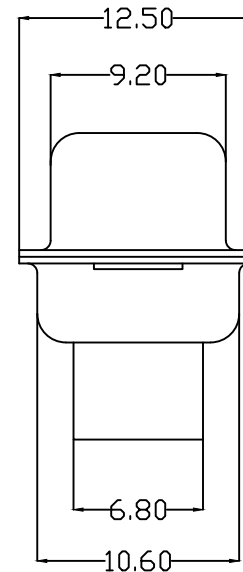
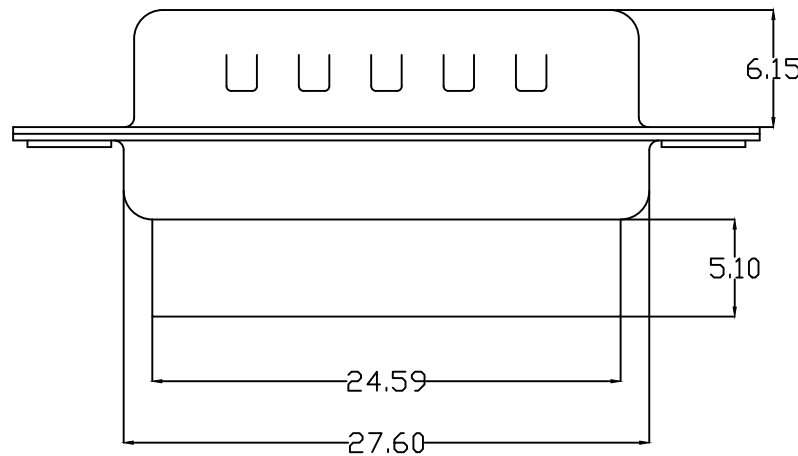

UNLESS OTHERWISE SPECIFIED TOLERANCE	
ANG.	±5°
0.	±0.5
.0	±0.3
.00	±0.2

QIANGTS 深圳市强泰盛电子有限公司
 Shenzhen Qiangtaisheng Electronic Co. LTD.
 TEL.:86-755-82599792 FAX:86-755-27313473

SCALE: AS SHOWN	UNIT: mm
DRAWN WAN	07/07/08
CHECKED CHEN	07/07/08
APPROVED CHEN	07/07/08
DATE 06/17/13	SIZE A4

DRAWN NAME: HDEC26 male end type optical hole
PRODUCT NO. 110A26M1X
FILE NAME: 110A26M1X

REV.	DESCRIPTION	DATE
A	ECN-20130617001(WAN)	06/17/13