

P.C.B LAYOUT

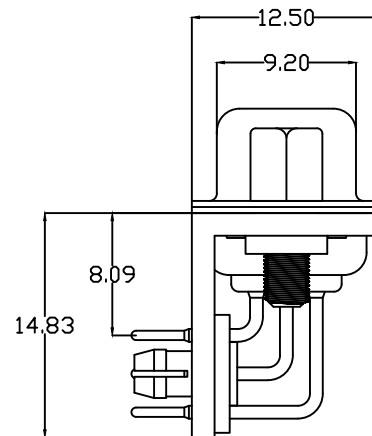

Specification of screws

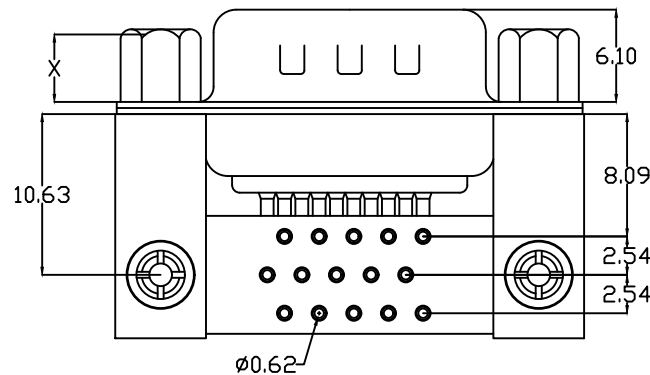
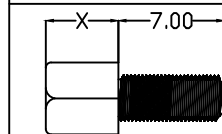

Part number	Xsize	In the teeth
A/C	4.8	4#40
B/D	5.8	4#40

Instructions:

- Features:
 - Rated voltage :500V AC MIN
 - Rated current :5A
 - Impedance of contact :30mΩ MAX.
 - Resistance of insulation :3000MΩ MIN. at 500V DC
 - Voltage resistance value:500V AC RMS for 1minute
 - Scope of work : -55°C~+105°C
 - Shell salt spray : More than 48H
- Material:
 - Rubber core : PBT rated
 - Car PIN : Copper alloy
 - The shell : Iron alloy/Copper alloy/Stainless steel front shell with nickel plating and rear shell with tin plating/passivation
 - Stents : Iron alloy, copper alloy, nickel plating
 - The harpoon : Copper alloy, nickel plated
 - The rivet : Copper alloy, nickel plated
 - Screw : Iron/copper alloy, nickel plated
 - Baffle : PA9T, yellow

106G 15 M X X XX C X X 4 B X
1 2 3 4 5 6 7 8 9 10 11 12

- Serial number:
 - 106G=HDR car pin riveting
- PIN bit differentiation:
 - 15=15PIN 26=26PIN 44=44PIN
 - 62=62PIN 78=78PIN
- Male female distinction:
 - F=The mother M=The male
- Distinction of plastic:
 - 1=PBT White glue 2=PBT vinyl
- Terminal material differentiation:
 - H=brass P=Phosphor copper
- The terminal electroplating μs are differentiated:
 - 01=1u gold AA=1.5u gold 02=2u gold.....
- Terminal Specifications Distinction:
 - C=conventional
- Division of shell:
 - 1=The iron shell 2=Copper shell
 - 3=Passivation of stainless steel
 - 4=Stainless steel nickel plating
- Differentiation of bracket:
 - D=10.63 Iron support with plate
 - J=10.63 Copper bracket with plate
- Harpoon distinction:
 - 4= Four prong harpoon
- Rivet differentiation:
 - B=5.4*4.4*1.2 rivet
- Screw differentiation:
 - A=4.8 Iron screw B=5.8 Iron screw
 - C=4.8 Copper screw D=5.8 Copper screw

UNLESS OTHERWISE SPECIFIED TOLERANCE
ANG. ±5'
0. ±0.5
.0 ±0.3
.00 ±0.2

SCALE: AS SHOWN UNIT: mm

DRAWN WAN 06/17/13

CHECKED CHEN 06/17/13

APPROVED CHEN 06/17/13

DATE

SIZE A4 REV. A



深圳市强泰盛电子有限公司
Shenzhen Qiangtaisheng Electronic Co. LTD.
TEL:86-755-82599792 FAX:86-755-27313473

DRAWN NAME: HDR15 bus needle with plate riveting lock

PRODUCT NO. 106G15MXXXXCXX4BX

FILE NAME: 106G15MXXXXCXX4BX

REV.	DESCRIPTION	DATE	SIZE	REV.	FILE NAME:
A	ECN-20130617001(WAN)	06/17/13	A4	A	106G15MXXXXCXX4BX