

Instructions:

1. Features:

- The rated voltage :500V AC MIN
- Rated current :5A
- Contact impedance :30mΩ MAX.
- Insulation impedance :3000MΩMIN. at 500V DC
- Resistance to voltage value :500V AC RMS for 1minute
- The scope of work : -55℃--+105℃
- The shell salt fog : More than 48 H

2. Material:

- Rubber core : PBT rated
- Car PIN : Copper alloy
- The shell : ferroalloy/Copper alloyThe front shell is nickel plated and the rear shell is tin plated

202A 50 F X X XX C X
 1 2 3 4 5 6 7 8

1. Series number:

202A=DB head car needle light hole

2. PIN a distinction between:

- 09=9PIN 15=15PIN 25=25PIN
- 37=37PIN 50=50PIN

3. Male female to distinguish:

F=The mother M=The male

4. Plastic to distinguish:

1=PBT White glue 2=PBT vinyl

5. Terminal material differentiation:

H=brass P=Phosphor copper

6. The terminal electroplating μs are differentiated:

01=1u gold AA=1.5u gold 02=2u gold.....

7. Terminal Specifications Distinction:

C=conventional

8. The shell to distinguish:

1=The iron shell 2=Copper shell

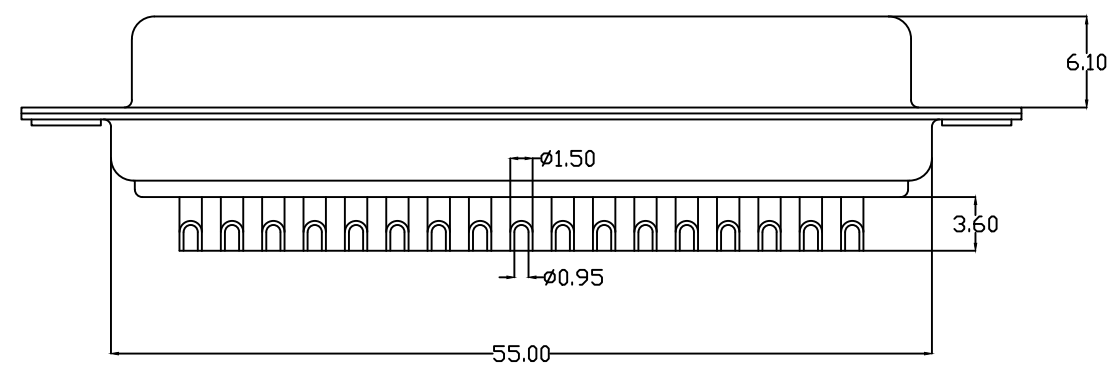
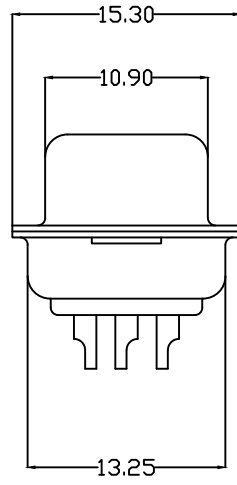

UNLESS OTHERWISE SPECIFIED TOLERANCE	
ANG.	±5°
0.	±0.5
.0	±0.3
.00	±0.2

QIANGTS 深圳市强泰盛电子有限公司
 Shenzhen Qiangtaisheng Electronic Co. LTD.
 TEL.:86-755-82599792 FAX:86-755-27313473

SCALE: AS SHOWN	UNIT: mm
DRAWN WAN	06/17/13
CHECKED CHEN	06/17/13
APPROVED CHEN	06/17/13

DRAWN NAME:	DB50 female car needle light hole
PRODUCT NO.	202A50FXXXXCX
FILE NAME:	202A50FXXXXCX

REV.	DESCRIPTION	DATE
A	ECN-20130617001(WAN)	06/17/13