

Instructions:

1. Features:

- The rated voltage :500V AC MIN
- Rated current :5A
- Contact impedance :30mΩ MAX.
- Insulation impedance :3000MΩ MIN. at 500V DC
- Resistance to voltage value :500V AC RMS for 1Minute
- The scope of work : -55℃+105℃
- The shell salt fog : More than 48 H

2. Material:

- Rubber core : PBT rated
- Car PIN : Copper alloy
- The shell : ferroalloy/Copper alloy/Stainless steel front shell with nickel plating and rear shell with tin plating/passivation

202A 37 M X X XX C X
 1 2 3 4 5 6 7 8

1. Series number:

202A=DB head car needle light hole

2. PIN a distinction between:

09=9PIN 15=15PIN 25=25PIN
 37=37PIN 50=50PIN

3. Male female to distinguish:

F=The mother M=The male

4. Plastic to distinguish:

1=PBT White glue 2=PBT vinyl

5. Terminal material differentiation:

H=brass P=Phosphor copper

6. The terminal electroplating μs are differentiated:

01=1u gold AA=1.5u gold 02=2u gold....

7. Terminal Specifications Distinction:

C=conventional

8. The shell to distinguish:

- 1=The iron shell 2=Copper shell
- 3=Passivation of stainless steel
- 4=Stainless steel nickel plating

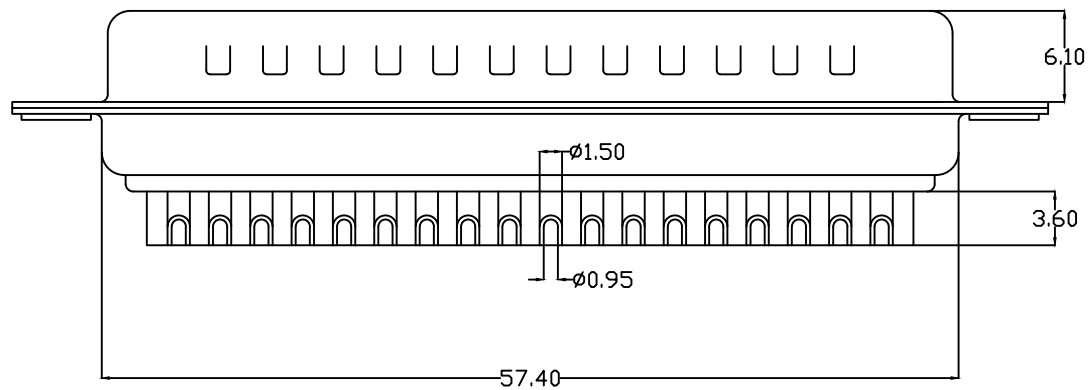
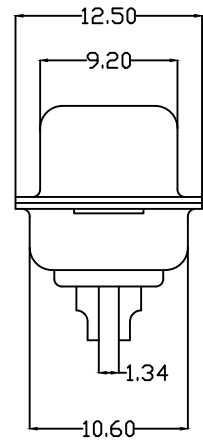

UNLESS OTHERWISE SPECIFIED TOLERANCE	
ANG.	±5°
0.	±0.5
.0	±0.3
.00	±0.2

QIANGTS 深圳市强泰盛电子有限公司
 Shenzhen Qiangtaisheng Electronic Co. LTD.
 TEL:86-755-8259792 FAX:86-755-27313473

SCALE: AS SHOWN	UNIT: mm
DRAWN WAN	06/17/13
CHECKED CHEN	06/17/13
APPROVED CHEN	06/17/13

DRAWN NAME:	DB37 bus needle light hole
PRODUCT NO.	202A37MXXXXCX
FILE NAME:	202A37MXXXXCX

REV.	DESCRIPTION	DATE
A	ECN-20130617001(WAN)	06/17/13

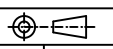

SIZE A4 REV. A