

Nut specification			
	Part Number	Xsize	Internal tooth
X	A	4.8	4#40
	B	5.8	4#40

Explain:

- Characteristic:
  - Rated voltage :500V AC MIN
  - Rated current :5A
  - Contact impedance :30mΩ MAX.
  - Insulation impedance :3000MΩ MIN. at 500V DC
  - Withstand voltage value :500V AC RMS for 1Minute
  - Scope of work : -55°C~+105°C
  - Shell salt spray : Above 48H
- Material Science:
  - Rubber core : PBT rated
  - Car PIN : copper alloy
  - Housing : ferroalloy/copper alloy/Stainless steel front shell nickel plating and rear shell tin plating/passivation
  - Bracket : PBT/LCP, black
  - Harpoon : ferroalloy/Copper alloy, tin plated
  - Nut : Copper alloy, nickel plated

208H 37 F X X XX C X X X X  
 1 2 3 4 5 6 7 8 9 10 11

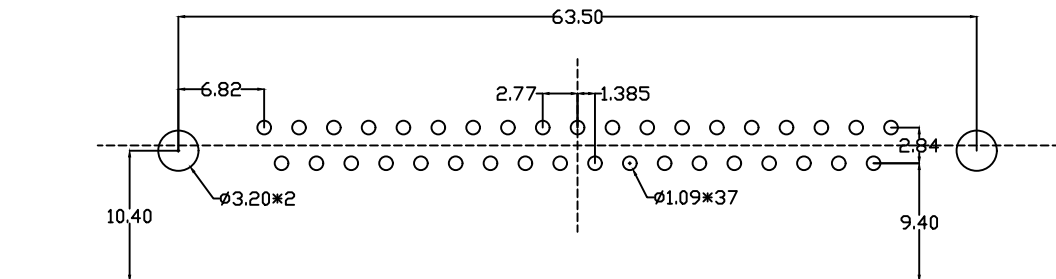
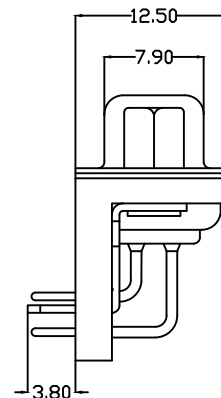
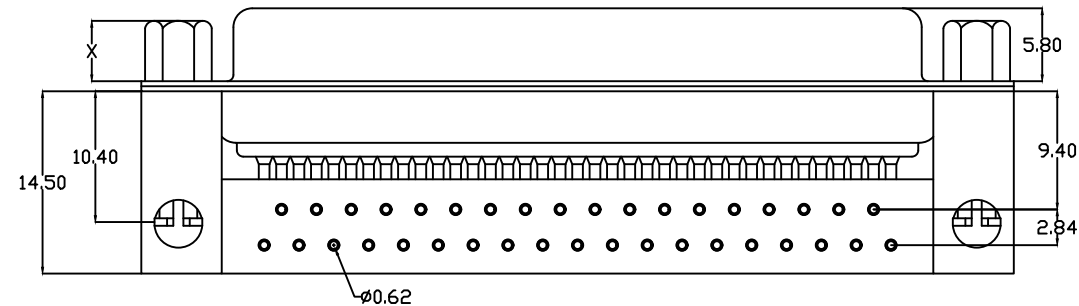

P.C.B LAYOUT

- Serial number:
  - 208H=DR needle bending 9.4 Front rivet hollow nut with bracket
- PIN distinguishing:
  - 09=9PIN 15=15PIN 25=25PIN 37=37PIN 50=50PIN
- Male female distinction:
  - F=mother M=male
- Plastic division:
  - 1=PBT White glue 2=PBT Black glue
- Terminal material differentiation:
  - H=brass P=Phosphor copper
- Terminal electroplating μ Numerical differentiation:
  - 01=1u gold AA=1.5u gold 02=2u gold....
- Terminal specification differentiation:
  - C=routine
- Enclosure differentiation:
  - 1=Iron shell 2=Copper shell 3=Stainless steel passivation 4=Stainless steel nickel plating
- Support differentiation:
  - A=PBT B=LCP
- Harpoon distinction:
  - 1=Iron harpoon 12H 2=Iron harpoon 24H 3=Copper harpoon
- Nut distinction:
  - A=4.8 Nut B=5.8 Nut

UNLESS OTHERWISE SPECIFIED TOLERANCE  
 ANG. ±5'  
 0. ±0.5  
 .0 ±0.3  
 .00 ±0.2

SCALE: AS SHOWN UNIT: mm

**QIANGTS** 深圳市强泰盛电子有限公司  
 Shenzhen Qiangtaisheng Electronic Co. LTD.  
 TEL:86-755-82599792 FAX:86-755-27313473

DRAWN WAN 06/17/13  
 CHECKED CHEN 06/17/13

DRAWN NAME: DR37 mother car needle bending 9.4 front rivet hollow nut with bracket  
 PRODUCT NO. 208H37FXXXXCXXXX

APPROVED CHEN 06/17/13

FILE NAME: 208H37FXXXXCXXXX

REV.	DESCRIPTION	DATE
A	ECN-20130617001(WAN)	06/17/13