

P.C.B LAYOUT

Instructions:  
 1. Features:  
 The rated voltage :500V AC MIN  
 Rated current :5A  
 Contact impedance :30mΩ MAX.  
 Insulation impedance :3000Ω MIN. at 500V DC  
 Resistance to voltage value :500V AC RMS for 1Minute  
 The scope of work : -55℃~+105℃  
 The shell salt fog : More than 48 H  
 2. Material:  
 Rubber core : PBT rated  
 Car PIN : Copper alloy  
 The shell : ferroalloy/Copper alloy/Stainless steel front shell with nickel plating and rear shell with tin plating/passivation  
 Stents : PBT/LCP, black  
 The harpoon : ferroalloy/Copper alloy, tin plated  
 The rivet : Copper alloy, nickel plated  
 Screw : ferroalloy/Copper alloy, nickel plated

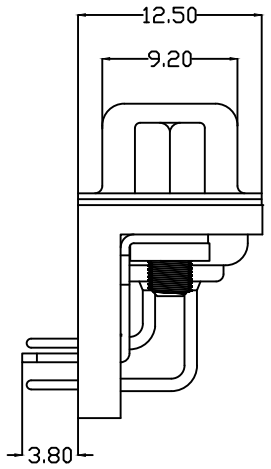
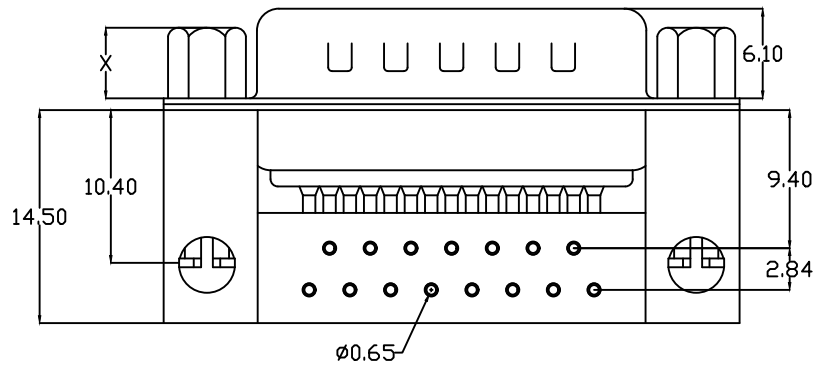

- 208G 15 M X X XX C X X X A X  
 1 2 3 4 5 6 7 8 9 10 11 12
- Series number:  
208G=DR Needle bend 9.4 rivet lock
  - PIN a distinction between:  
09=9PIN 15=15PIN 25=25PIN  
37=37PIN 50=50PIN
  - Male female to distinguish:  
F=The mother M=The male
  - Plastic to distinguish:  
1=PBT White glue 2=PBT vinyl
  - Terminal material differentiation:  
H=brass P=Phosphor copper
  - The terminal electroplating μs are differentiated:  
01=1u gold AA=1.5u gold 02=2u gold.....
  - Terminal Specifications Distinction:  
C=conventional
  - The shell to distinguish:  
1=The iron shell 2=Copper shell  
3=Passivation of stainless steel  
4=Stainless steel nickel plating
  - Support to distinguish:  
A=PBT B=LCP
  - The harpoon to distinguish:  
1=Iron spear 12 H 2=Iron spear for 24 H  
3=Bronze spear
  - Rivet to distinguish:  
A=5.4\*5.1\*1.2 The rivet
  - Screw to distinguish:  
A=4.8 Iron screw B=5.8 Iron screw  
C=4.8 Copper screw D=5.8 Copper screw

螺丝规格

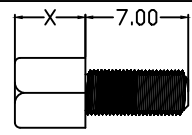

零件编号	X尺寸	内牙
	4.8	4#40
	5.8	4#40

UNLESS OTHERWISE SPECIFIED TOLERANCE	
ANG.	±5°
0.	±0.5
.0	±0.3
.00	±0.2

**QIANGTS** 深圳市强泰盛电子有限公司  
 Shenzhen Qiangtaisheng Electronic Co. LTD.  
 TEL.:86-755-82599792 FAX:86-755-27313473

SCALE: AS SHOWN	UNIT: mm
DRAWN WAN	06/17/13
CHECKED CHEN	06/17/13
APPROVED CHEN	06/17/13

DRAWN NAME:	DR15 bus pin bend 9.4 rivet lock
PRODUCT NO.	208G15MXXXXCXXXAX
FILE NAME:	208G15MXXXXCXXXAX

REV.	DESCRIPTION	DATE	SIZE	REV.
A	ECN-20130617001(WAN)	06/17/13	A4	A